

This document sketches out the main menus (please refer to operating manual MU 7051 EN for further information)

USING THE BUTTONS OF THE MICROCOMPT+

- - Come back to the previous step
- Increment the blinking Digit
- - Choose the menu options
- Select the next digit
- Display the delivery information
- - Validate the menu option
- Validate the data
- Validate the default

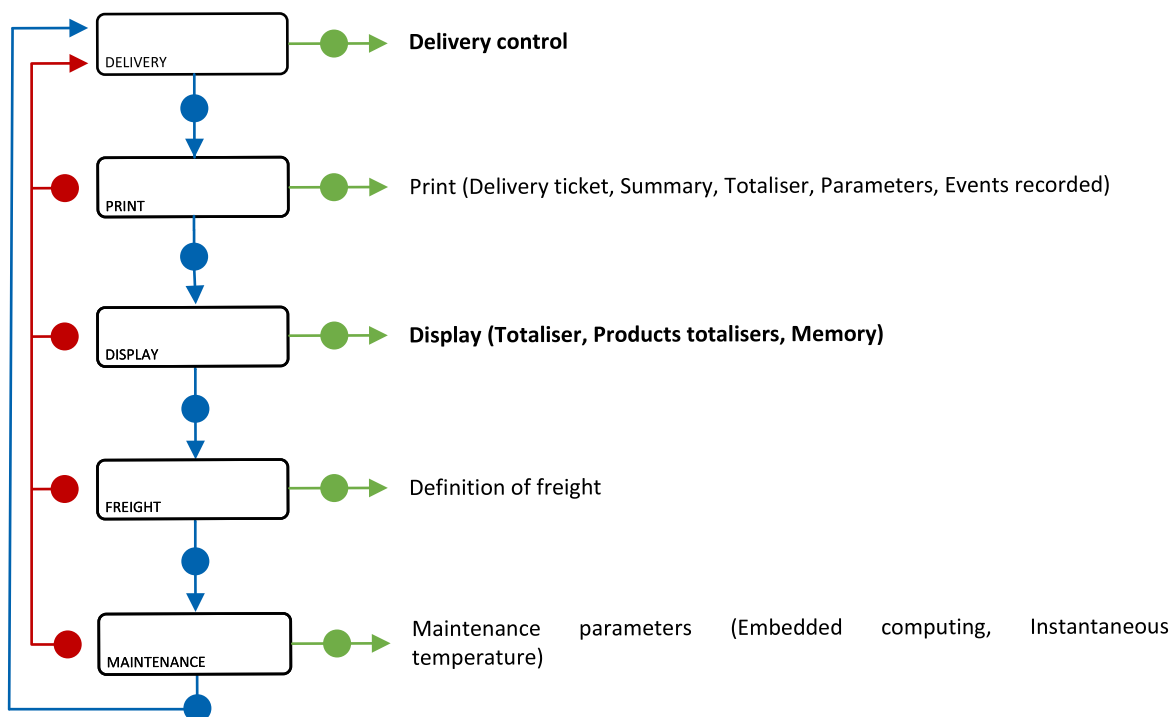

RUN A DELIVERY

1. PREPARE THE DELIVERY

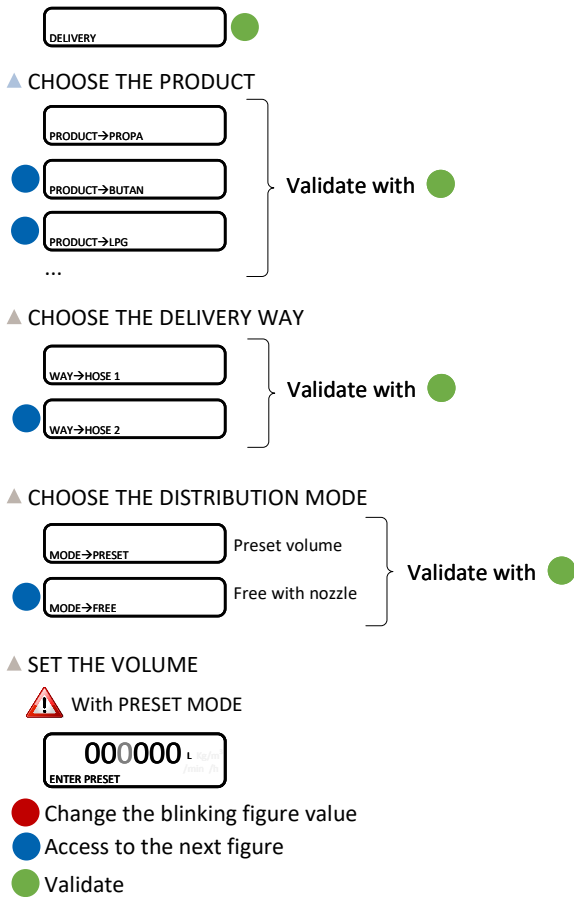

2. CARRY OUT THE DELIVERY

▲ START THE DELIVERY



Display during the delivery:

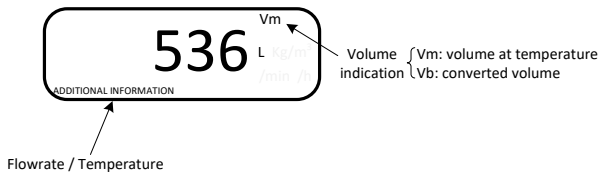

Interruption of the delivery

► APPEARANCE OF A FAULT AND DISPLAY OF AN ALARM

(see list of alarms)

● Continue or stop the delivery (§3)

► INTENTIONAL INTERRUPTION OF THE OPERATION

STOP DELIVERY

● Continue or stop the delivery (§3)

Display the delivery information

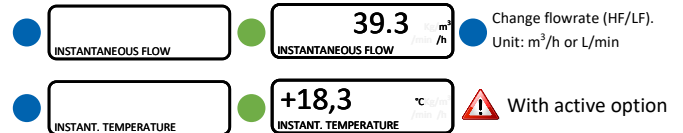

Back to normal display is automatic: DO NOT PRESS RED STOP BUTTON TO KEEP FROM INTERRUPTING OPERATION.

3. CONTINUE OR STOP THE DELIVERY

▲ CONTINUE THE DELIVERY

1285 L $\frac{L}{min}$ Vm
 CONTINUE DELIVERY?

● Start the delivery (§2)

▲ STOP THE DELIVERY

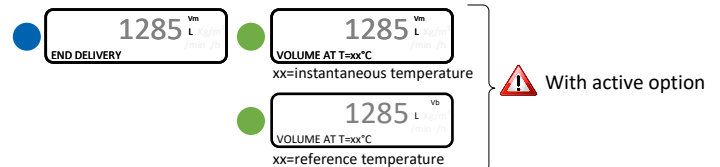

● Temperature is displayed ⚠ With active option

✋ If temperature is not displayed, enter the value

● Print the delivery ticket §4 ⚠ With active option

4. PRINT THE DELIVERY TICKET

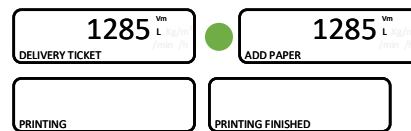

Back to main menu

MEANING OF SYMBOLS

▲ Mandatory action

▲ Optional action

► Event during delivery

✋ Action by operator

DISPLAY THE DELIVERY DATA

The DISPLAY menu is available in stand-by mode or in case of an intermediate stop

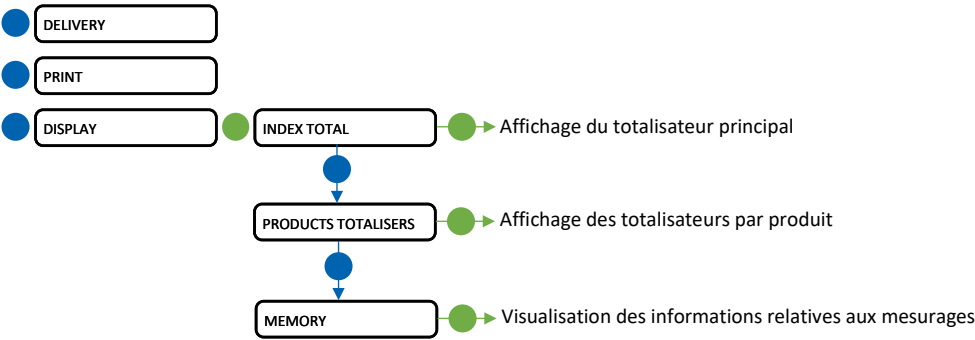

INDEX TOTAL

In case of a dispute, those indications provide proof

00011

L kg/m³
/min /h

INDEX TOTAL 00011548

548

L kg/m³
/min /h

INDEX TOTAL 00011548

PRODUCTS TOTALISERS

In case of a dispute, those indications provide proof

00002

L kg/m³
/min /h

1/PROPA 00002161

161

L kg/m³
/min /h

1/PROPA 00002161

00003

L kg/m³
/min /h

2/BUTAN 00003827

827

L kg/m³
/min /h

2/BUTAN 00003827

MEMORY

In case of a dispute, those indications provide proof

COMPLETE LIST

004207

INDICATOR REFERENCE

296

DAY NUMBER

016

MEASUREMENT NUMBER

002044

L kg/m³
/min /h

PRODUCT N°X/XXX

+12.8

°C

TEMPERATURE

With active option

DAY SELECTION

004207

INDICATOR REFERENCE

296

DAY NUMBER

008

MEASUREMENT NUMBER

001030

L kg/m³
/min /h

PRODUCT N°X/XXX

+14.3

°C

TEMPERATURE

COMPLETE LIST: Display all the deliveries details recorded, from the newest to the oldest

DAY SELECTION: Display a specific delivery details by selecting the day number (1 to 365), then the measurement number

LIST OF ALARMS

		DISPLAY	MEANING	ACTION
USER		STOP DELIVERY	Intentional interruption of delivery	Continue or end the delivery
		COMMUNICATION FAULT	Communication with the printer lost	Check the connection cable, on-off switch and fuse
		POWER SUPPLY PROBLEM	Power outage during delivery	Check the cause / Restore power supply
		ZERO FLOW DEFAULT	Zero flow	Check if the pulse transmitter is powered (red indicators)
		HIGH FLOW DEFAULT	High flowrate (greater than maximal flowrate)	Check the parameters / Reduce flowrate
		METERING PROBLEM	Metering problem with the measuring device	Check if the pulse transmitter is powered (red indicators)
		PTO DEFAULT	Coherence failure with power take-off	Check the power take-off status in driver's cab
		HOSE BURST	Flowrate variation caused by a hose burst	The delivery is stopped automatically
		DIARY DEFAULT	Reset of the events diary	Acknowledge the alarm, check the date in supervisor mode (RFID key)
		Three tricolour LED on the MICROCOMPT+ front face are showing the wireless connection status as described in the operating manual MU 7051		
REPARATOR	NON BLOCKING	DISPLAY DEFAULT	Problem with display card	If steady alarm, substitution of the display card
		WATCHDOG DEFAULT	Fault with display or power card or AFSEC+ card	Switch on-off the MICROCOMPT+ / If steady alarm, substitution of the faulty card
		TOTALISER LOST	Loss of totaliser	Substitution of the backup battery
		TEMPERATURE DEFAULT	Temperature determination failure	Check the temperature probe / If steady alarm, see a reparator for trouble shooting
		MEMORY LOST (PILE)	Loss of saved memory	Substitution of the backup battery
		MEMORY LOST	Error on SIM memorization	Enter and exit the METROLOGICAL mode / If steady alarm, substitution of the backup battery
		DATE AND TIME LOST	Loss of date and time	Set date and time in supervisor mode (RFID key)
	BLOCKING	COEFFICIENTS DEFAULT	Deviation between coefficient LF/HF greater than 0.5%	Modification of the low flow coefficient (K1)
		PROM DEFAULT	Loss of software or resident integrity	Substitution of the AFSEC+ electronic card
		RAM DEFAULT	Saved memory fault	Substitution of the AFSEC+ electronic card
		EEPROM MEMORY LOST	Loss of metrological configuration	Substitution of the AFSEC+ electronic card
		MEMORY OVER LOADED	SIM memory full	Substitution of the AFSEC+ electronic card